

Layer upon Layer

Problem One

- How many cubes are in this pyramid?
- How many cubes would be needed altogether if the pyramid had another layer added to the bottom?

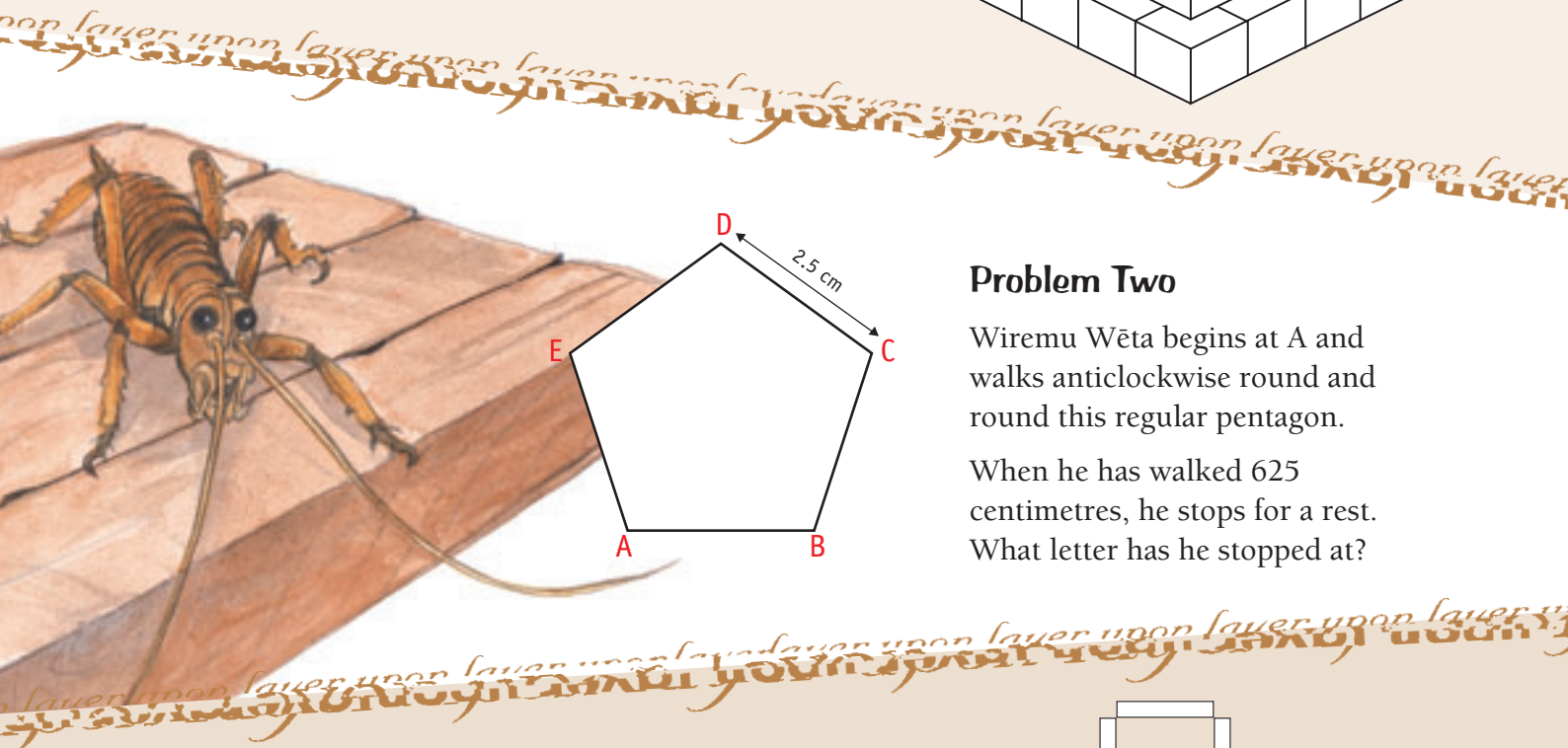
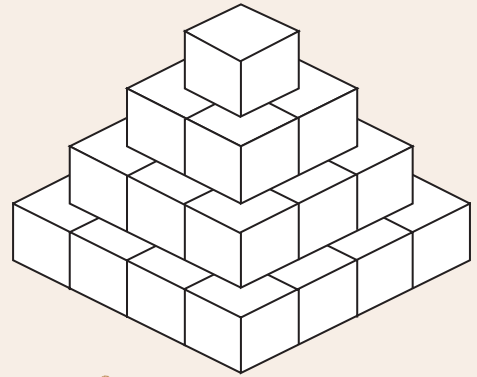

Problem Two

Wiremu Wēta begins at A and walks anticlockwise round and round this regular pentagon.

When he has walked 625 centimetres, he stops for a rest. What letter has he stopped at?

Problem Three

- How many sticks would you need to make the same shape as this with sides that are twice as long?
- How much bigger would the new shape be?

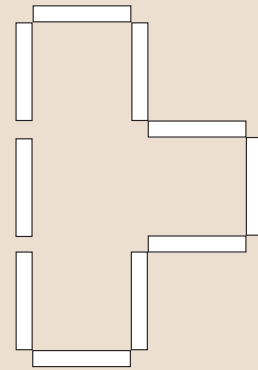

Problem Four

In this T-shirt pattern, what number will be on the T-shirt that Tui is hanging up?

